

REV.	DESCRIPTION	DATE	APPROVED
1	ECO 200319	1/2/2007	

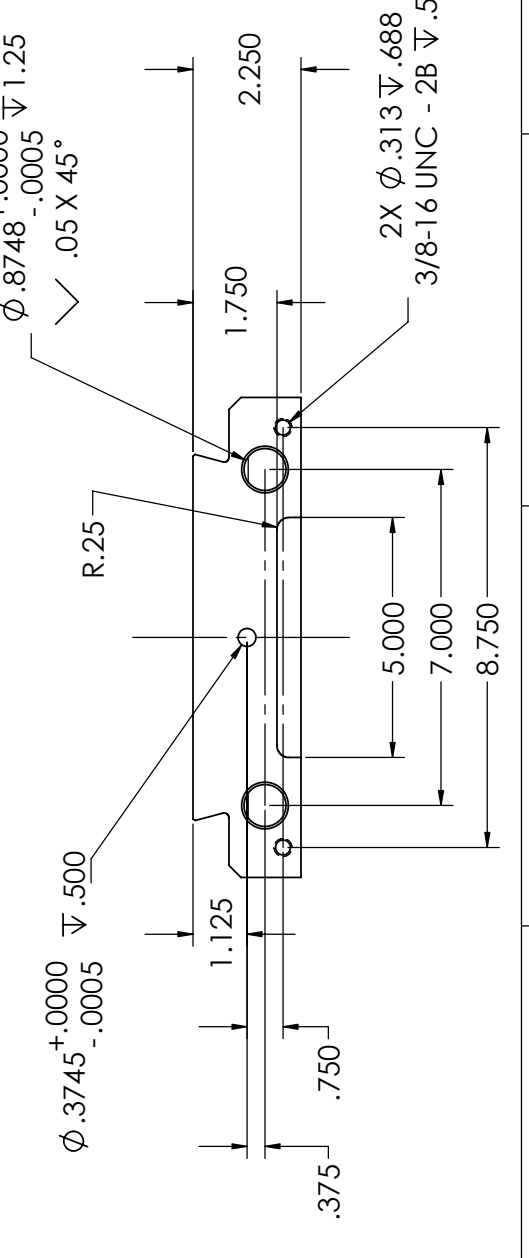
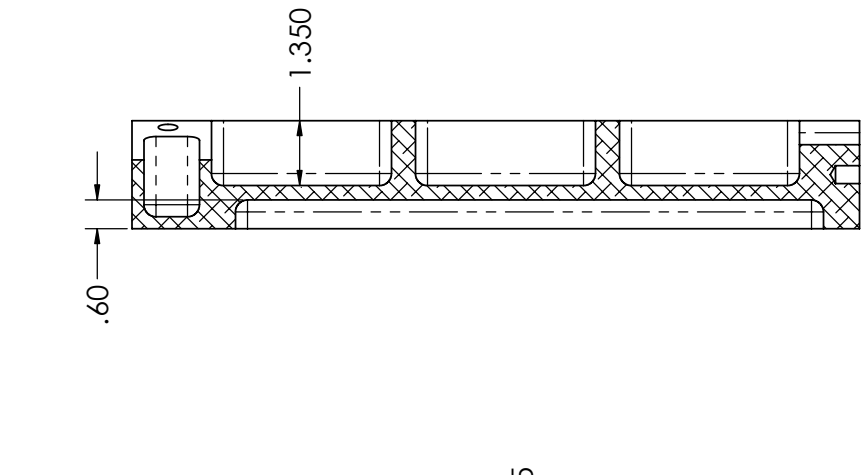
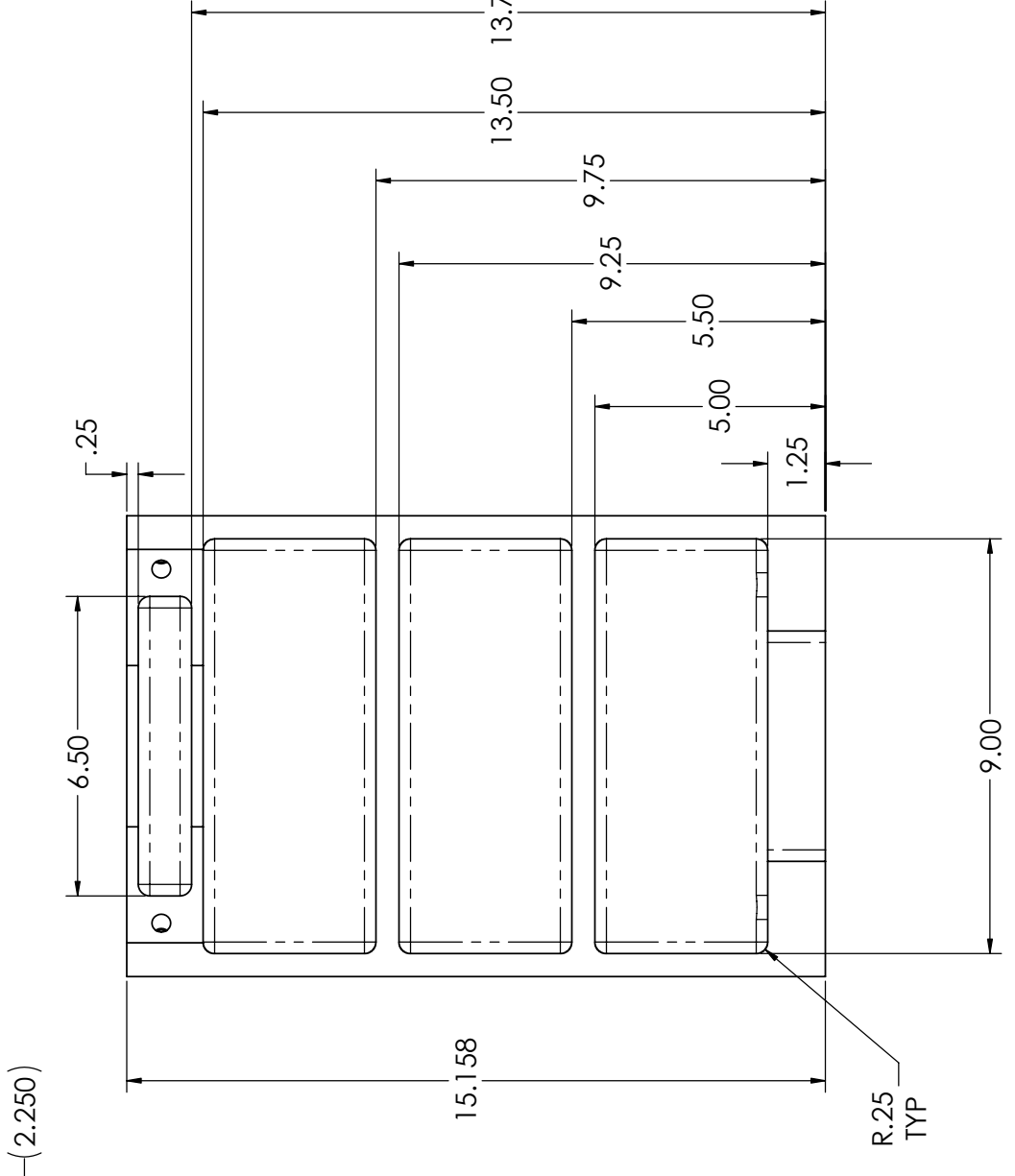
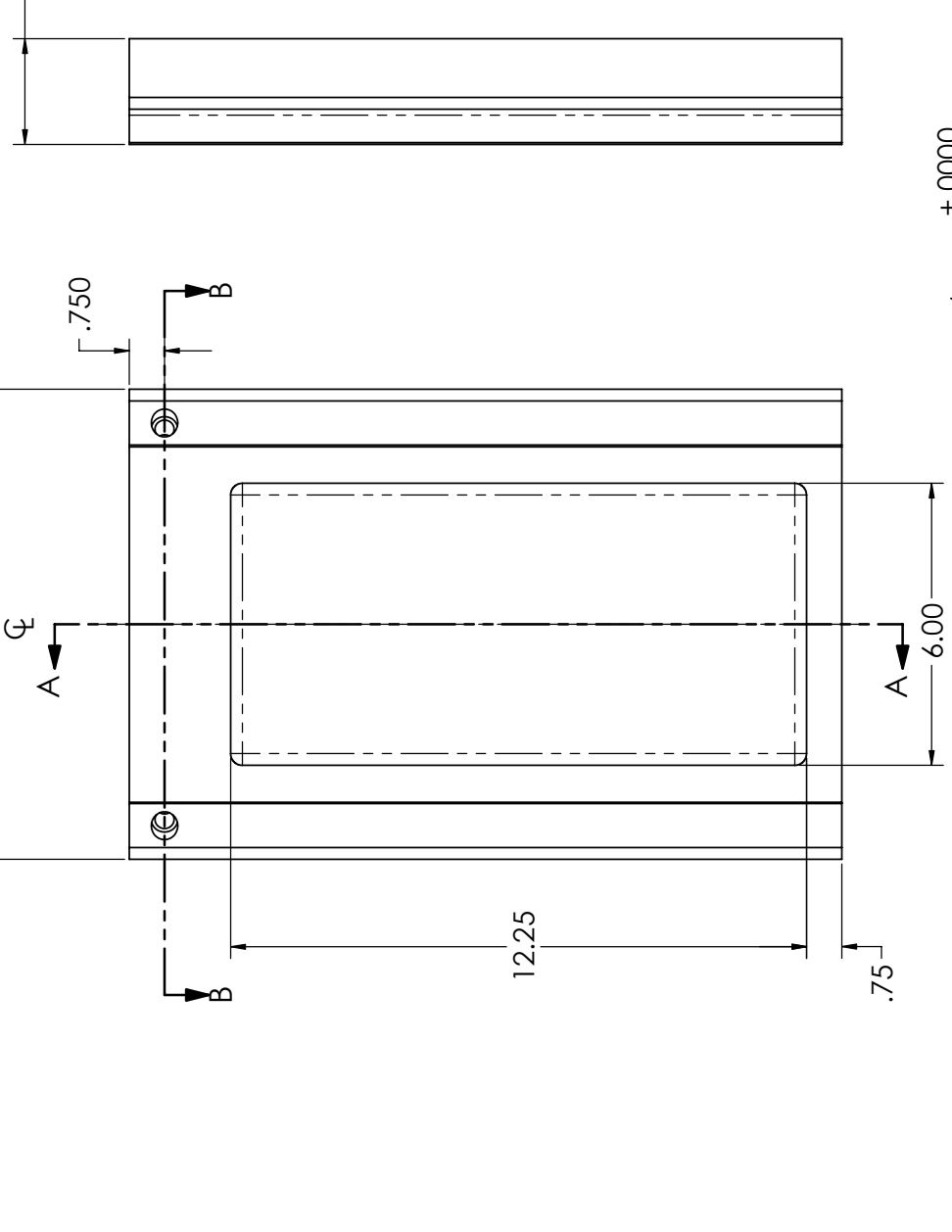
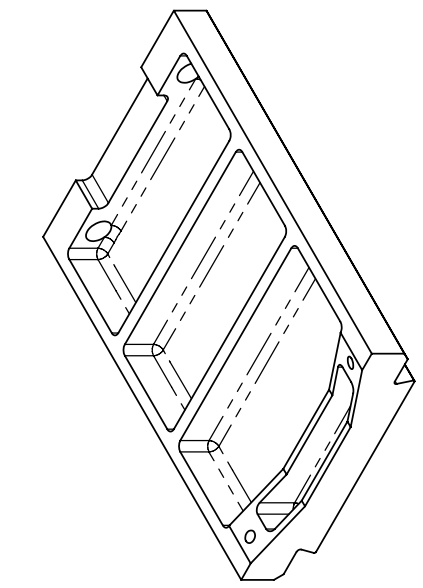
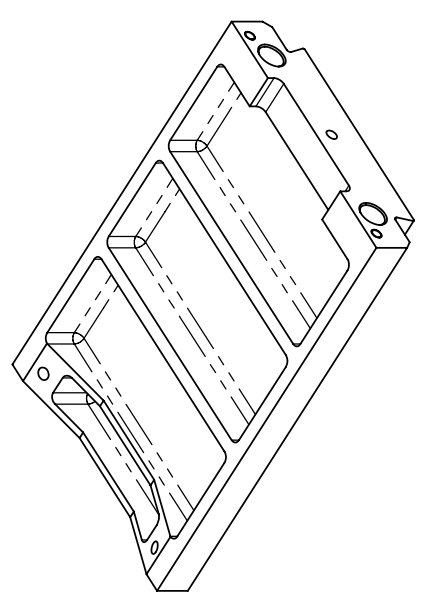
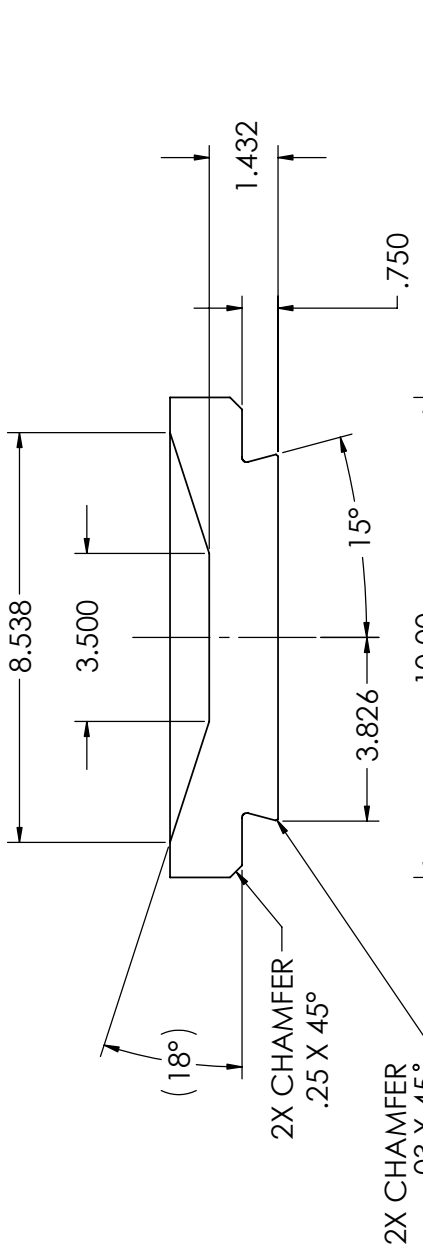

SECTION A-A

SECTION B-B

- NOTES:
- REMOVE ALL SHARP EDGES.
  - FINISH: BLACK ANODIZE PER MIL-A-8625, TYPE II, CLASS 2

UNLESS OTHERWISE SPECIFIED	NAME	DATE
DECIMAL DIM	W. ZHOU	7/15/06
ANGULAR DIM		
LOCATIONS		
FORMED TO		
CHANGES		
SURFACE FINISH		
MAKE GOOD		
BREAK ALL SHARP EDGES & REMOVE BURRS		
PROPRIETARY AND CONFIDENTIAL		
IN THE CASE OF ANY DISCREPANCY BETWEEN THIS DRAWING AND THE PART AS MANUFACTURED BY THE PART MANUFACTURER THIS PART SHALL GOVERN		

DRAWN	DATE	<b>PLANEWAVE Instruments</b>
CHECKED		
ENG APPR.		
MATERIAL		
6061-T6 AL ALLOY		PLATE, DOVETAILED - PWI
THICK		
SEE NOTE	DWG. NO.	200319
	REV.	
		B